

1. 50 Yards Vänster

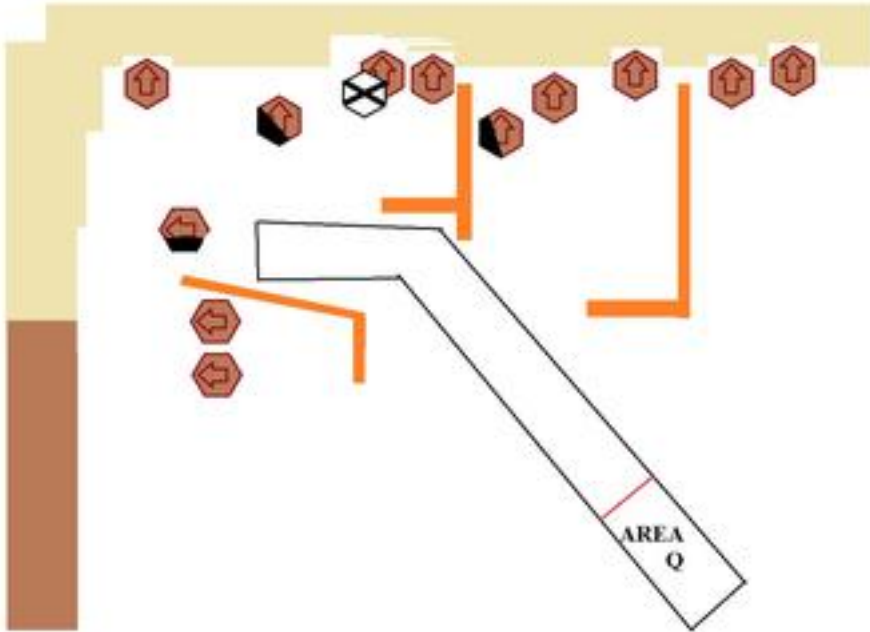

| | | | |
|---------|----------------------------|------------|--------|
| CoF | Comstock - Medium | Points | 120 p |
| Targets | 12 paper, Total 12 targets | Min rounds | 24 |
| Firearm | Handgun | Match-% | 16.00% |

| | |
|-------------------------|---------------------|
| Procedure | On signal - Engage. |
| Starting position | Stading i Area Q |
| Firearm ready condition | |
| Start on | Audible signal |
| Stop on | Last shot |
| Penalties | |
| Safety angles | L/R |
| Setup notes | |

2. 50 Yards Höger

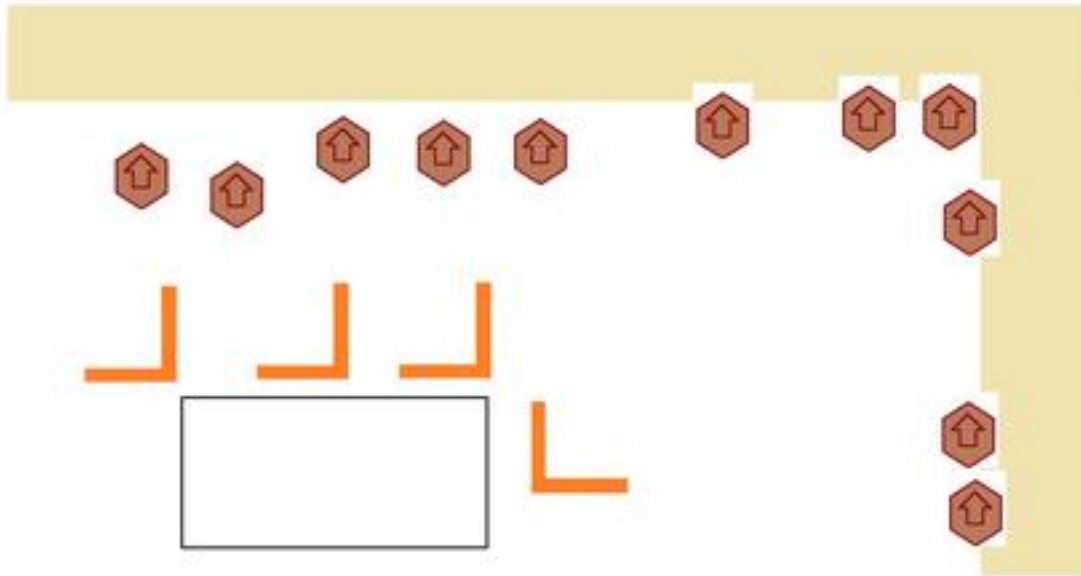

| | | | |
|---------|----------------------------|------------|--------|
| CoF | Comstock - Medium | Points | 110 p |
| Targets | 11 paper, Total 11 targets | Min rounds | 22 |
| Firearm | Handgun | Match-% | 14.67% |

| | |
|-------------------------|---------------------|
| Procedure | On signal - Engage! |
| Starting position | Standing |
| Firearm ready condition | |
| Start on | Audible signal |
| Stop on | Last shot |
| Penalties | |
| Safety angles | L/R |
| Setup notes | |

3. A Banan

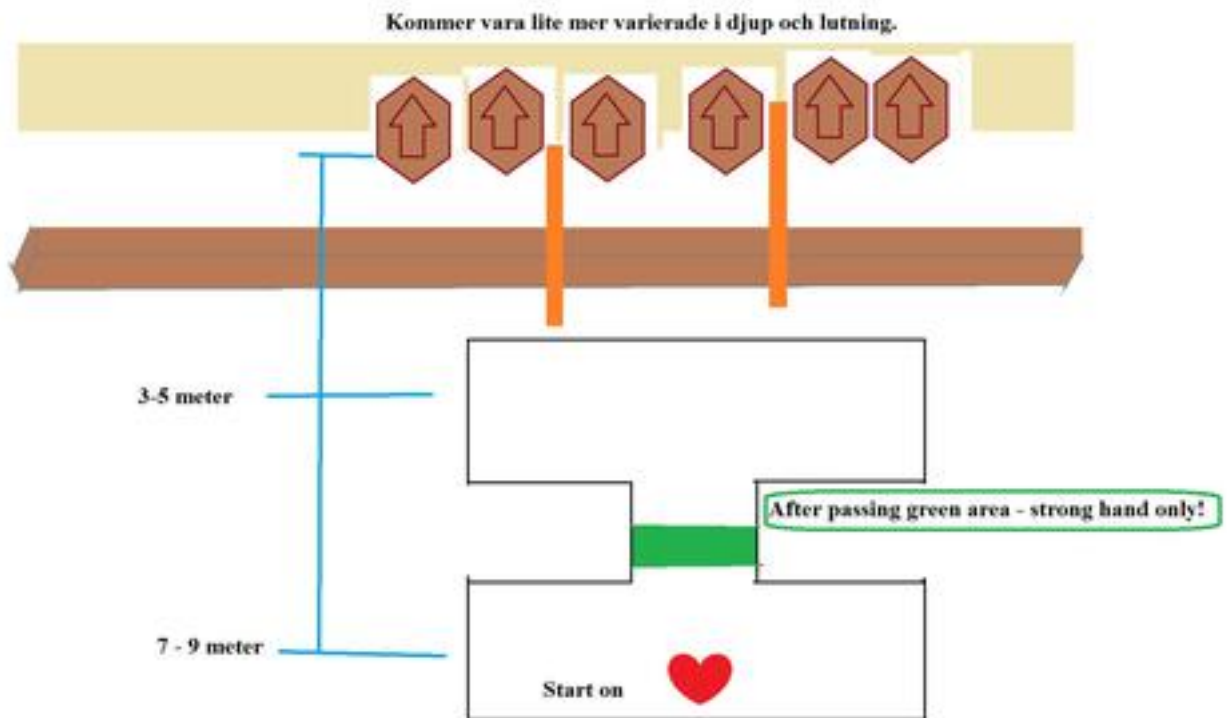

| | | | |
|---------|--------------------------|------------|-------|
| CoF | Comstock - Short | Points | 60 p |
| Targets | 6 paper, Total 6 targets | Min rounds | 12 |
| Firearm | Handgun | Match-% | 8.00% |

| | |
|-------------------------|---|
| Procedure | On signal - Engage! After/If crossing the green mark - all shooting Strong hand only. |
| Starting position | Standing on mark |
| Firearm ready condition | |
| Start on | Audible signal |
| Stop on | Last shot |
| Penalties | |
| Safety angles | L/R |
| Setup notes | |

4. IPSC Bay

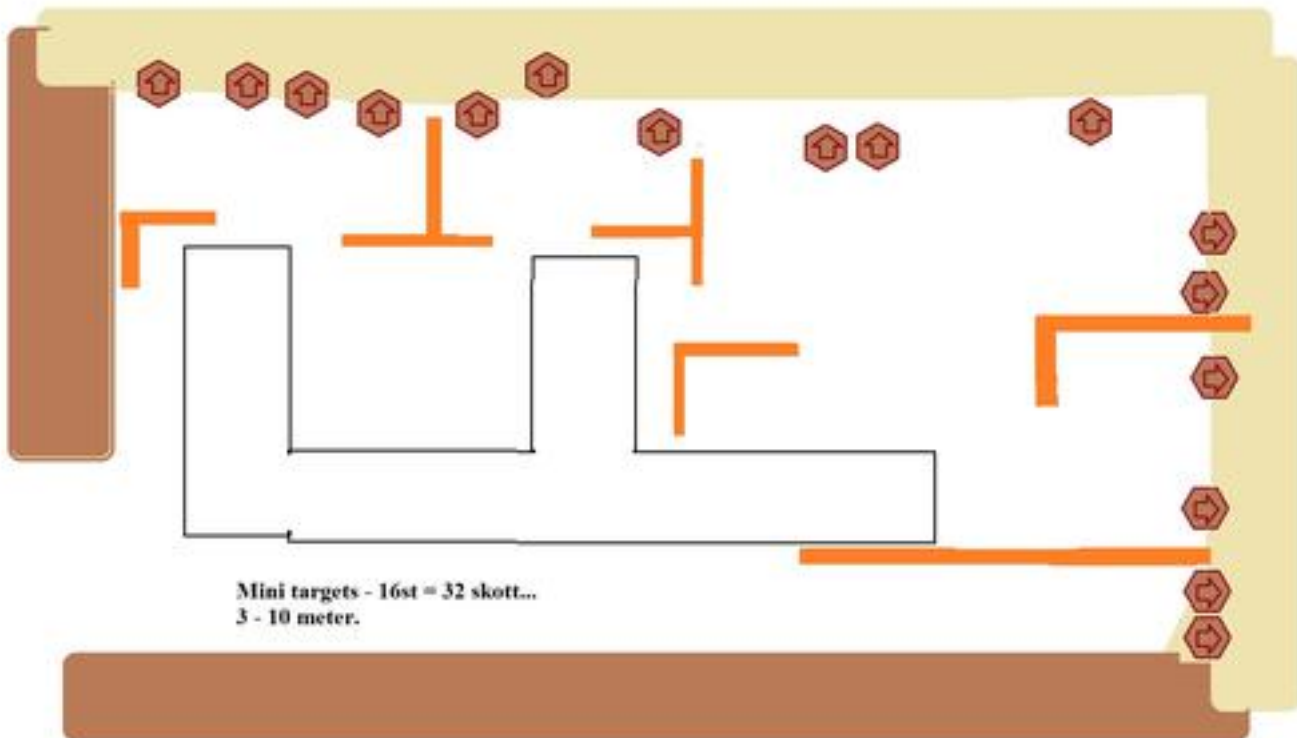

| | | | |
|---------|----------------------------|------------|--------|
| CoF | Comstock - Long | Points | 160 p |
| Targets | 16 paper, Total 16 targets | Min rounds | 32 |
| Firearm | Handgun | Match-% | 21.33% |

| | |
|-------------------------|---------------------|
| Procedure | On signal - Engage! |
| Starting position | Standing |
| Firearm ready condition | |
| Start on | Audible signal |
| Stop on | Last shot |
| Penalties | |
| Safety angles | L/R |
| Setup notes | |

5. 50 Yards Vänster Ombyggd

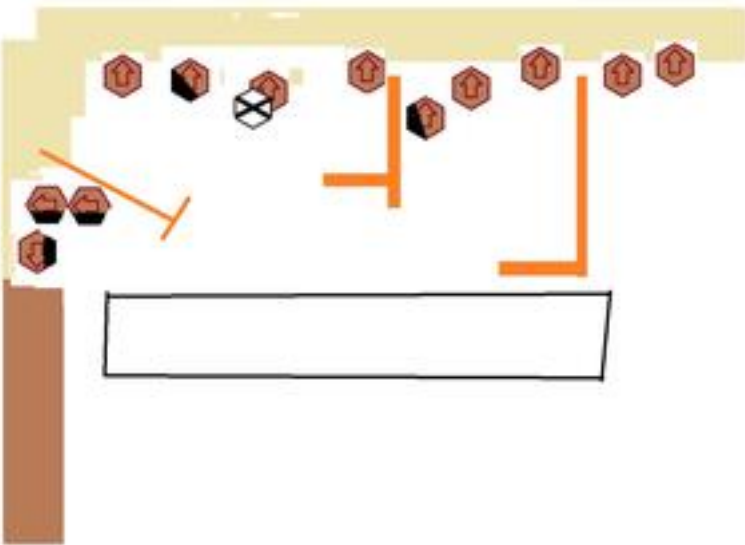

| | | | |
|---------|----------------------------|------------|--------|
| CoF | Comstock - Medium | Points | 120 p |
| Targets | 12 paper, Total 12 targets | Min rounds | 24 |
| Firearm | Handgun | Match-% | 16.00% |

| | |
|-------------------------|---------------------|
| Procedure | On signal - Engage! |
| Starting position | Standing |
| Firearm ready condition | |
| Start on | Audible signal |
| Stop on | Last shot |
| Penalties | |
| Safety angles | L/R |
| Setup notes | |

6. 50 Yards Höger Ombyggd

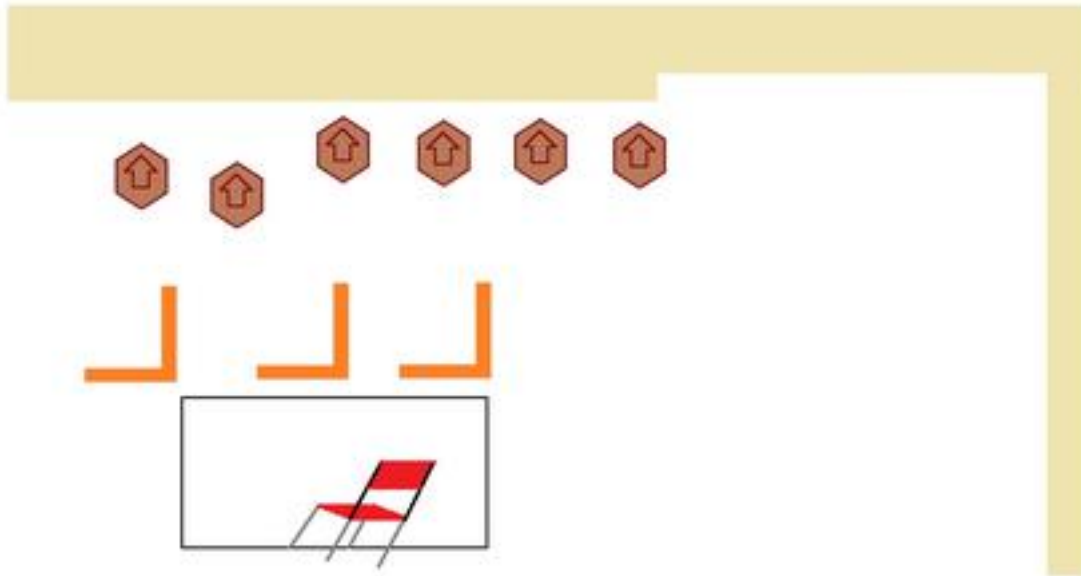

| | | | |
|---------|--------------------------|------------|-------|
| CoF | Comstock - Short | Points | 60 p |
| Targets | 6 paper, Total 6 targets | Min rounds | 12 |
| Firearm | Handgun | Match-% | 8.00% |

| | |
|-------------------------|---|
| Procedure | On signal - Engage! |
| Starting position | Sitting with both buttocks on chair. Hands on knees - shown By RO |
| Firearm ready condition | Empty Chamber - Empty magazinewell |
| Start on | Audible signal |
| Stop on | Last shot |
| Penalties | |
| Safety angles | L/R |
| Setup notes | |

7. A Banan Ombyggd

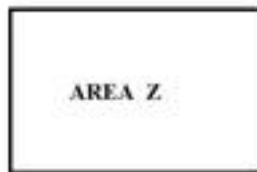
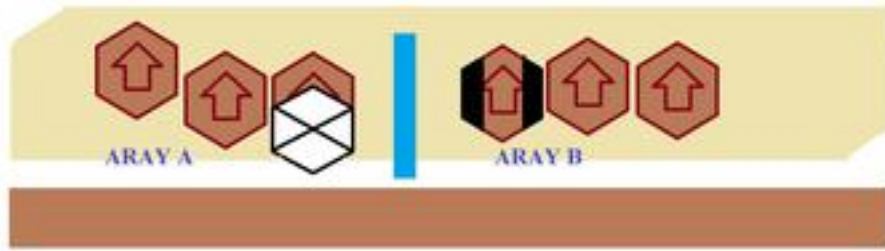

| | | | |
|---------|--------------------------|------------|-------|
| CoF | Comstock - Short | Points | 60 p |
| Targets | 6 paper, Total 6 targets | Min rounds | 12 |
| Firearm | Handgun | Match-% | 8.00% |

| | |
|-------------------------|---|
| Procedure | On signal engage targets in Aray A or B - then engage the other Aray, strong hand only. |
| Starting position | Standing |
| Firearm ready condition | |
| Start on | Audible signal |
| Stop on | Last shot |
| Penalties | |
| Safety angles | L/R |
| Setup notes | |

8. IPSC Bay Ombyggd

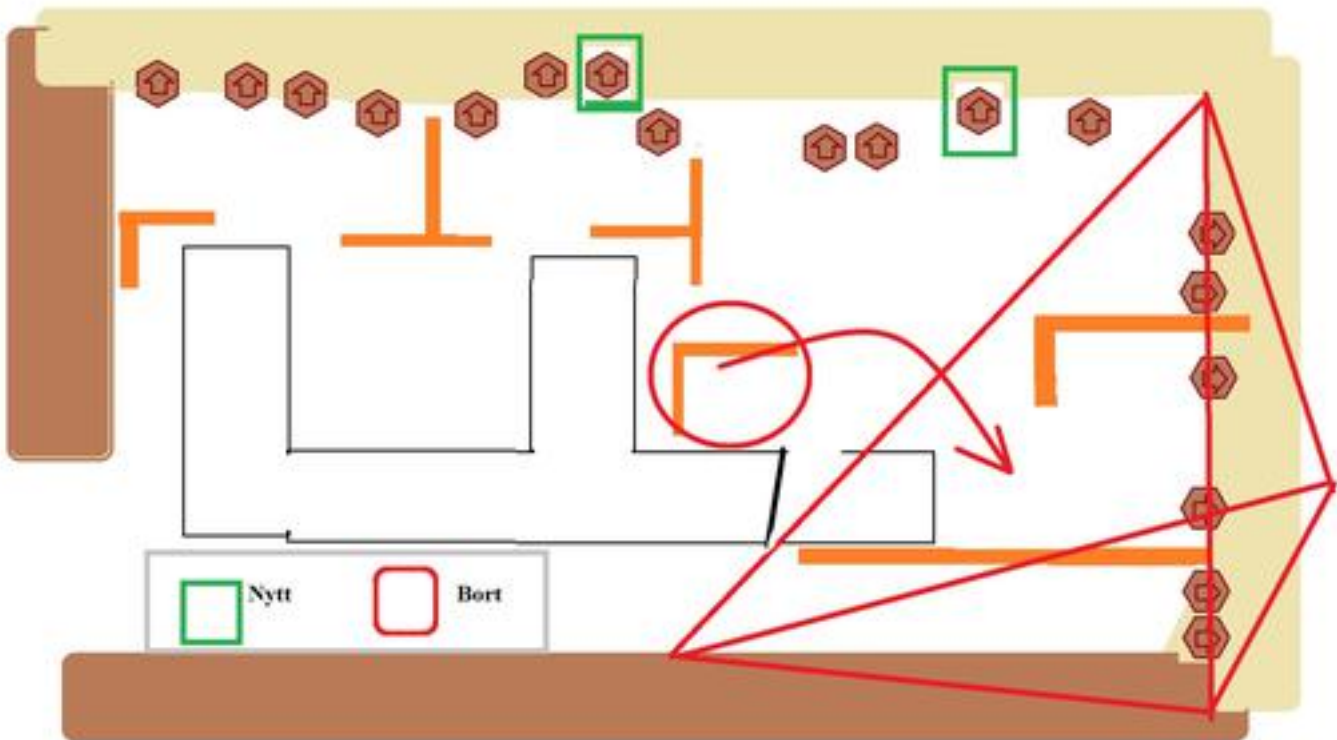

| | | | |
|---------|----------------------------|------------|-------|
| CoF | Comstock - Short | Points | 60 p |
| Targets | 12 paper, Total 12 targets | Min rounds | 12 |
| Firearm | Handgun | Match-% | 8.00% |

| | |
|-------------------------|---|
| Procedure | On signal - engage targets with a minimum of 1 (one) round/target - best hit/target will score. |
| Starting position | Standing |
| Firearm ready condition | |
| Start on | Audible signal |
| Stop on | Last shot |
| Penalties | |
| Safety angles | L/R |
| Setup notes | |